

HFL/S3H MOUNTING INSTRUCTIONS

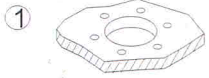

1. Drill one 57mm/ 2 $\frac{1}{4}$ " hole and six 5.2mm/ $\frac{13}{64}$ " holes in the tank.



2. Thread the first screw (any of the 6) complete through the HFL flange and the gasket and the other 5 screws through the HFL flange and a little through the gasket. Look at the drawing and place the "C" ring on the first screw.

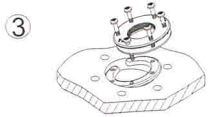

3. Twist the "C" ring into the tank opening, and line up the "C" ring until you can screw down one of the 5 screws. Take out the first screw.

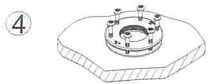

4. Line up the "C" ring and loosely screw all the screws evenly into the "C" ring.

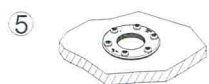

5. Tighten the screws evenly in a star pattern.

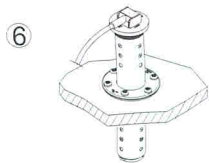

6. Screw the sender onto the HFL flange with spanner.

You may use your own way to assemble the flange and sender unit. The following instruction may prevent you to loose the parts down into the holding tank.

In accordance with SAE international assembly standard.